

**2025 WORLDINK MEDICAL BHRT CME WORKSHOP SEMINAR SERIES  
TORONTO, ON., CANADA – LIVE IN PERSON IN TORONTO**

**Hotel Block Discount + Travel Details + Airports**

**BHRT CME SERIES - PART I - IV - Advanced BHRT Certification (ABHRT)**

**Mastering the Protocols for Optimization of Hormone Replacement**

**PART I: Discover the Power of BHRT Fundamentals**

**Friday, September 19 to Sunday, September 21 – Westin Harbour Castle Hotel, Toronto Lakefront**

**Education Schedule – Live Conference – EST TIME**

Friday: 8:00am – 6:00pm

Saturday: 8:00am – 6:00pm

Sunday: 8:00am – 12:00pm - Course is complete

Meals: Breakfast + lunch + AM + PM breaks – served onsite beside the conference room

**Toronto Workshop Details + Agenda + Full Brochures**

<https://www.trubalancehealthcare.com/education>

**The PART I Course Includes**

- E- syllabus /digital files
- Medical references/ evidence based course
- CME credits & evaluation
- Community Access – APIM Membership with Worldlink Medical – Free with PART I
- <https://worldlinkmedical.com/members-benefits/>

**Optimal Audience**

Medical Doctor, Nurse Practitioner, Endocrinologist, Gynecologist, Medical Doctor in Residency, Cardiologist, Radiologist, Urologist, Functional Medicine Practitioners, Registered Nurse, Registered Practical Nurse, Healthcare Coach, Naturopathic Doctor, Doctor of Osteopathic Medicine, Sports Doctor, Weight Loss Practitioner, Physician Assistant, International Medical Graduate, etc.

**Education is open across borders to licensed practitioners**

**Westin Harbour Castle Hotel - Hotel Block Rate: \$379.00CAD + tax per night**

Hotel is located on the lakefront across from Porter Airlines at Billy Bishop Toronto City Airport (Island)

**Hotel block rate expires August 28<sup>th</sup>, or if the room block sells out first**

Main telephone: 416.869.1600

Reservations tel#: 1.888.627.8559

Reserve online: [Link to hotel](#)

Main website: [Westin hotel photo's](#)

**Parking:** Valet parking onsite only or public parking in area, 5 minute walk

**Public Transit - Union Station:** 15 minute walk to hotel - <https://torontounion.ca/>

**Nearest Airports:** Toronto Pearson International Airport + Billy Bishop Toronto City Airport/Lakefront

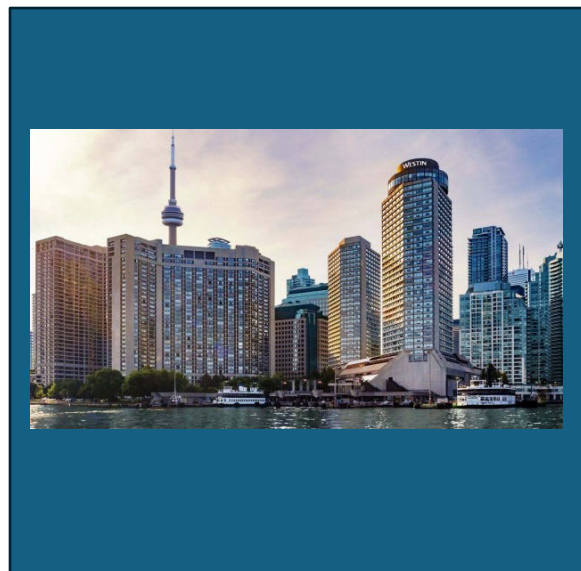

**2025 WORLDINK MEDICAL BHRT CME WORKSHOP SEMINAR SERIES  
TORONTO, ON., CANADA – LIVE IN PERSON COURSES IN TORONTO**

**Hotel Block Discount + Travel Details + Airports**

**BHRT CME SERIES - PART I – IV - Advanced BHRT Certification (ABHRT)  
Mastering the Protocols for Optimization of Hormone Replacement**

**PART II: Expand Treatment Options with Advanced Concepts**

**Friday, June 6 to Sunday, June 8**

**Sheraton Gateway Hotel attached to Toronto Pearson International Airport, Terminal 3**

**Education Schedule – Live Conference – EST TIME**

Friday: 8:00am – 6:00pm

Saturday: 8:00am – 6:00pm

Sunday: 8:00am – 12:00pm - Course is complete

Meals: Breakfast + lunch + AM + PM breaks – served onsite beside the conference room

**Toronto Workshop Details + Agenda + Full Brochures**

<https://www.trubalancehealthcare.com/education>

**The PART II Course Includes**

- E- syllabus /digital files
- Medical references/ evidence based course
- CME credits & evaluation
- Check out the APIM Membership with Worldlink Medical – Community, Clinical & Library
- <https://worldlinkmedical.com/members-benefits/>

**Optimal Audience**

Medical Doctor, Nurse Practitioner, Endocrinologist, Gynecologist, Medical Doctor in Residency, Cardiologist, Radiologist, Urologist, Functional Medicine Practitioners, Registered Nurse, Registered Practical Nurse, Healthcare Coach, Naturopathic Doctor, Doctor of Osteopathic Medicine, Sports Doctor, Weight Loss Practitioner, Physician Assistant, International Medical Graduate, etc.

**Education is open across borders to medically licensed practitioners**

**Hotel Block Rate: \$289.00CAD + tax per night**

Super easy arrival, land at airport & take the train inside airport or walk to Terminal 3 – Sheraton Hotel

**Hotel block rate expires May 15th, or if the room block sells out first**

Main telephone: 905.972.7000

Reservations Tel#: 1.888.627.7092

Reserve online: [Direct hotel link](#)

Main website: [Marriot Sheraton Hotel](#)

**Parking:** Level 5 Rooftop Terminal 3, walk directly into the main hotel lobby\*\*special rate

**UPS Express Train:** Direct to downtown from the airport: \$12 one way - [Train link](#)

**Nearest Airports:** Toronto Pearson International Airport + Billy Bishop Toronto City Airport/ Lakefront

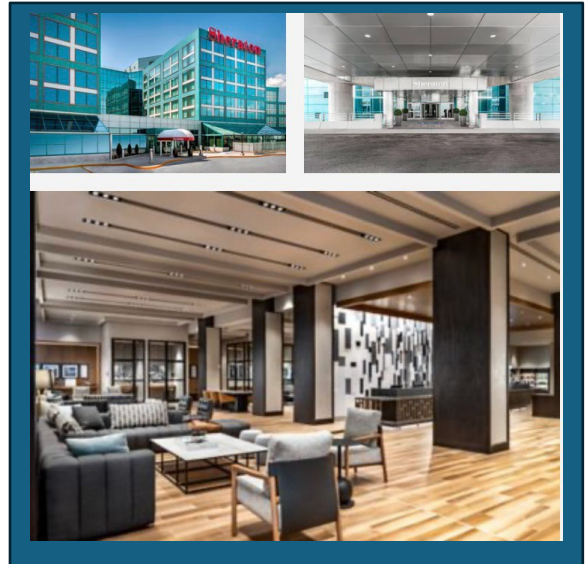

## 2025 WORLDLINK MEDICAL - USA BASED BHRT CME WORKSHOP SEMINAR SERIES

### USA BHRT SERIES IS HELD IN SALT LAKE CITY, UTAH ONLY

USA only, attend education live in person in Utah or virtually the same weekend  
or in Canada in person

### Hotel Block Discount + Travel Details + Airports

#### BHRT CME SERIES - PART I – IV - Advanced BHRT Certification (ABHRT)

#### Mastering the Protocols for Optimization of Hormone Replacement

**PART I:** Discover the Power of BHRT Fundamentals

**PART II:** Expand Treatment Options with Advanced Concepts

**PART III:** Investigate Complex BHRT Cases to Solve Troubling Symptoms

**PART IV:** Mastering the Practice for Hormone Optimization

#### Education Schedule – Mountain TIME

Friday: 8:00am – 6:00pm

Saturday: 8:00am – 6:00pm

Sunday: 8:00am – 12:00pm - Course is complete

#### USA Workshop dates are listed on both websites

[www.worldlinkmedical.com](http://www.worldlinkmedical.com)

[www.trubalancehealthcare.com/education](http://www.trubalancehealthcare.com/education)

#### Hotel Block Rates USA

All hotel information + hotel block rates + travel details can be found on the Worldlink Medical website  
Click on the link on the WLM website for the course you want to attend & scroll down to the bottom of the page for the hotel information

WLM organizes & books the USA hotels

<https://worldlinkmedical.com/events-cme/>

#### Early Bird Rate

Worldlink Medical offers \$100 off the course workshops

Rate expires 3 weeks from course start date

#### Nearest Airport

Salt Lake City International Airport (SLC)

<https://slcairport.com/>

#### For all communication, please contact:

**Donna A.G. Kingman**

Director of Business Development & Communications

International Cell: 647.884.0663 (text or call)

Email: [donna@trubalancehealthcare.com](mailto:donna@trubalancehealthcare.com)

[www.trubalancehealthcare.com/education](http://www.trubalancehealthcare.com/education)